



EDILMETAS



Via G.B. Pirelli - Z.I. La Martella
75100 Matera - ITALY



Tel. +39 0835.302804
Fax +39 0835.307942



info@edilmetas.it
www.edilmetas.it

1. FOREWORD

Thanks for choosing an EDILMETAS product, output of expertise, constant improving, quality assurance, accurate projects. We build respecting H&S standards environment and People.

This brochure has been elaborated according to regulations about design, building, commercialising and the correct use of our product.

We aim to deliver the best service to our customer, informing about the correct use of our product. We recommend to read carefully the booklet before installing and using this product.

Our Prefabs and Modular Buildings are worldwide famous for easy assembling, easy access and strong attention to details.

PRE-PAINTED
FRAMES

MODULAR
BUILDINGS

EASY
TO ASSEMBLE



* On request

1.1 Dimensions

Ref.	Internal Measures (mm)	External Measures (mm)	Weight (Kg)
MON314STAN	3140x2400xh2680	3000x2200xh2400	600
MON414STAN	4140x2400xh2680	4000x2200xh2400	800
MON514STAN	5140x2400xh2680	5000x2200xh2400	1000
MON614STAN	6140x2400xh2680	6000x2200xh2400	1200
MON814STAN	8140x2400xh2680	8000x2200xh2400	1600
MON1014STAN	10140x2400xh2680	10000x2200xh2400	2000
MON1214STAN	12140x2400xh2680	12000x2200xh2400	2400

Non-standard height

Ref.	Internal Measures (mm)	External Measures (mm)
H2700	2980	2700
H2200	2480	2200

Toilet

Ref.	Lateral Toilet	Weight (Kg)
V + L	Toilet+Sink; partition wall with door + lock, Vasistas Window mm 500x500; Cold water only, light and switch .	+100
V + L + D	Toilet+Sink+shower; partition wall with door + lock, Vasistas Window mm 500x500; 30 liter boiler, light and switch.	+150

Ref.	Central Toilet	Weight (Kg)
V + L CEN	Toilet+Sink; partition wall with door + lock, Vasistas Window mm 500x500; Cold water only, light and switch .	+200
V + L + D CEN	Toilet+Sink+shower; partition wall with door + lock, Vasistas Window mm 500x500; 30 liter boiler, light and switch.	+250

1.2 General Information

Structure:	The frames are made in galvanized pre-painted steel RAL 9001 Thickness 1,5 mm, from galvanised coils (standard: UNI 5753-75);
Base:	The base frame is made in galvanized pre-painted steel RAL 9001 Thickness 1,5 mm; with a galvanized steel sheet thickness 0,6 mm. Over the slab, a 18mm thick wood panel and an overlay PVC floor thick 2mm (waterproof).
Walls and Partitions	PUR insulated sandwich panels thickness 40 mm, Supporting steel structure thickness 0,4 mm according to UNI EN 10169, with PUR insulation D=38-40 Kg/mc Transmittance U=0,55 W/mqK.
Roof	PUR insulated sandwich panels thickness 30 or 40 mm*, Supporting steel structure thickness 0,4 mm according to UNI EN 10169, with PUR insulation D=38-40 Kg/mc. Over there, a corrugated galvanised steel sheet h=55 mm. Glass wool insulation on request*
Doors, Windows and Fixtures	Aluminium frame (bianco RAL 9010) complete of hardware and all use accessories. Glass thickness. 4 mm, protection bars, handles and locks. - Standard door dim. 1.050xh2.100 mm (890xh2.060 mm); - Double sliding window dim. 1.050xh1.100 mm - Vasistas Windows dim. 500x500 mm* Other fixtures available on request

Note:

Liftable with a crane, 4 points lifting eyes.

Water draining system on both the short sides.

Electrical System*	ITA-EU Standards – Earth, and circuit breaker.
Plumbing*	Made with exposed piping. Floor or Wall Drain. All independent. The customer will have to link them together and convey them.

1.3 Reference Standards

Reference, rules and specifications:

- Law 5/11/1971 nr. 1086 "Rules for the regulation of structural steel works;
- D.M. 14/01/2008 "Technical standards for buildings";
- D.P.R. 380/2001 "Consolidated text of the building industry and ss.mm.ii.";
- Dlgs 81/2008 - Implementation of Article 1 of the Law of 3 August 2007, n.123, in health and safety in the workplace.
- Standard UNI 10027 "Classification of structural steels".
- D.M. 37 of 22/01/2008 - Installation of installations inside the buildings.
- Reg. 305/2011

1.4 Load capacity

Maximum load on the roof (static) = 100 kg/sqm - Non walkable

Maximum load on the base (static)= 150 kg/sqm

*Maximum load capacity can be improved if required**

1.5 Disposal

In case of clearance, the owner or the holder must provide the correct disposal according to the local regulations.

We suggest to entrust a specialised company for carriage and dumping.

Take care about the environment.

————— Italian quality —————

Prefabs and Modular Buildings are designed and manufactured in our factory. We respect all regulations, our employees and H&S.

The use of the lifting eye is only for small and non frequent movements.

Roof is non-walkable.

————— EU Standards —————

We suggest further anchorage for caution and check the local regulation.

2 The materials

Every material we use for our buildings is certified, we guarantee the highest standards.

2.2 Panels (PUR insulation)

Our Panels are Made in Italy, the right compromise to guarantee efficiency and durability. The supporting sandwich panel, is white/grey, RAL 9001 and paintable or covered.

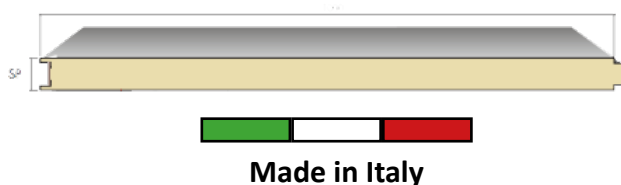

	sp. 30mm	sp. 40mm	sp. 50mm*
W/m ² K	0,62	0,55	0,44
Kcal/m ² h °C	0,53	0,47	0,38

The structure is constituted by metal sheet and is best option for walls and partitions. Respecting **EN 14509:2013**.

Characteristics	Class	Standards
Insulation	PUR	EN 14509
Density	40 Kg/m ³	EN 14509
Fire Reaction	F	UNI EN 14509 EN 13501-1

2.2 FIXTURES

Customisable and durable. Aluminium profiles painted (white RAL 9010) complete of all the accessories, glass sp. 4mm or other* complete of all accessories, protection bars, Handle and locks.

3 The structure

Our prefabs and modular buildings, are made using a special innovative lightweight and resistant frame. Easy to assemble and easy to join.

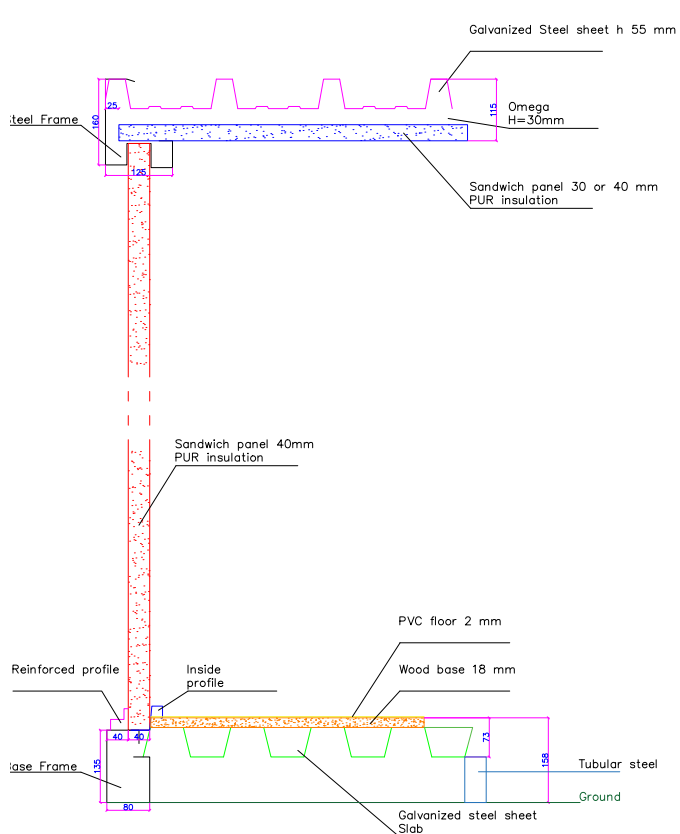

B.:Max load (static) 150 kg./mq – We can reinforce it as required

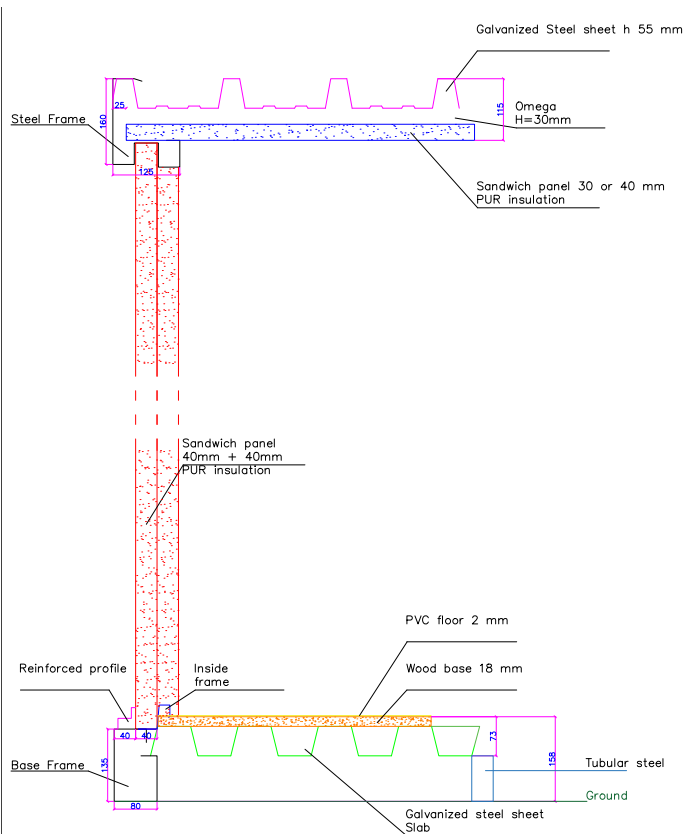

N.B.:Max load (static) 150 kg./mq – We can reinforce it as required

3 Assembling Modular Units

We manufacture simple and reliable solutions.
Our range:

- Assembled;
- Flat-pack base and roof pre assembled;
- Kit ready to assemble delivered disassembled;

Easy assembly and proven system.

Possibility of coupling two or more modules.

We use a special frame galvanized and pre-painted to deliver a nice looking product.

In the last 20 years, the increasing demand motivated the Company to improve the products, making these easier for our resellers, maintaining flexibility and affordable prices.

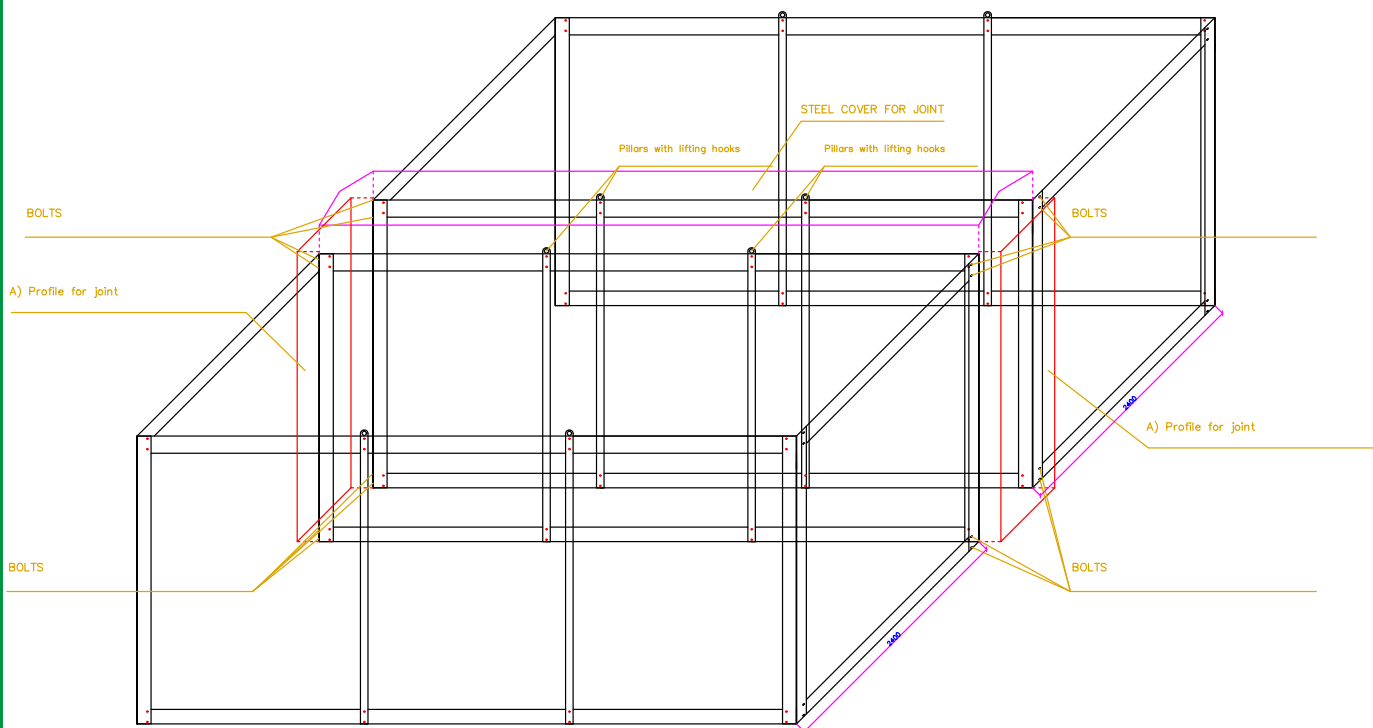
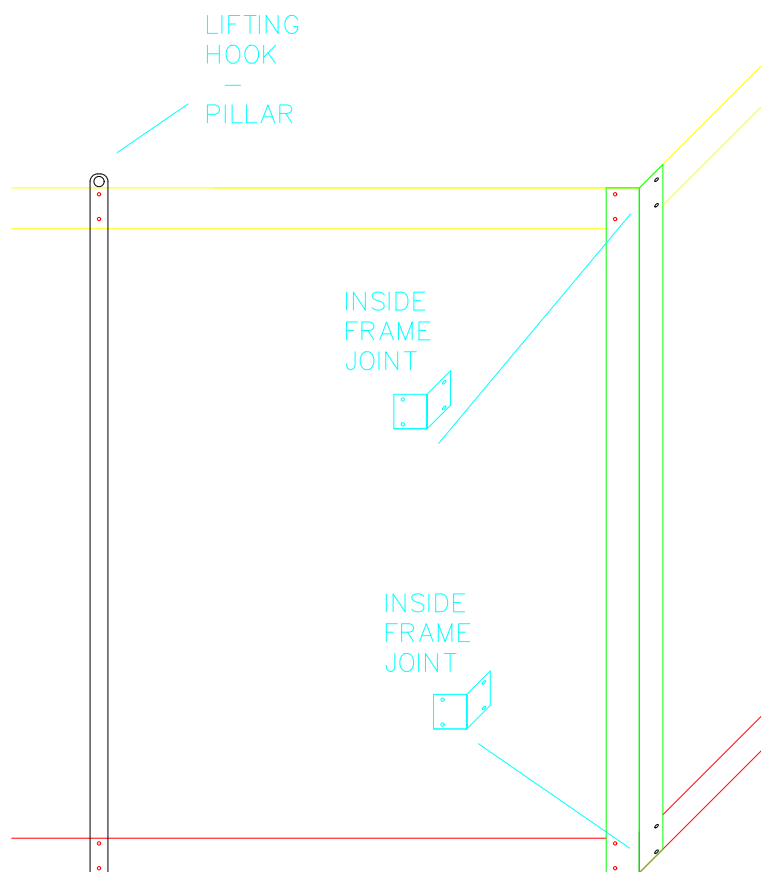

4. Flat pack or kit

The kit include pre-assembled base and roof, panels, bolts and fittings to assemble it on your site. Only 55cm high, easy to transport. Up to 10 on a full lorry. Electrical system*.



4.1 Modular

Up to 12 m, modular and easy to assemble.



4.2 ACCESSORIES



Description

Aluminum main door mm 1000x h 2100, ½ glass with protection bars, locks and handles
Aluminum inside door* for partitions, mm 800xh2100 with handles and locks
Partition walls: Sandwich panels PUR insulation 40mm.
Aluminum Double Sliding window, mm. 1000xh1200 with 4mm glass and protection bars.
Aluminium Vasistas Window mm 5000x500 with glazed 4mm glass.
Shower
Wall socket
Light Switch
Led or Neon Lights
Forklift pockets in tubular galvanized steel
AC Inverter 9000 BTU
CUSTOMISABLE WINDOWS, DOORS AND FIXTURES uPVC or Aluminum. High Efficiency Rating





CUSTOMISED
FIXTURES





5. Double Pitched Roof*

Made in galvanized tubular steel, with corrugated galvanized steel sheet or insulated sandwich panels*. Complete of draining pipes made in galvanized and painted steel. The ideal solution to protect by hot weather and rains.





EDILMETAS

A horizontal bar representing the Italian flag, with green, white, and red segments.

www.edilmetas.it

info@edilmetas.it